

Service
Service
Service



Philips Consumer Lifestyle

Service Manual

PRODUCT INFORMATION

General:

- Mains operation only
- World wide automatic voltage selection 100 - 240 Volt

Safety info

- This product meets the requirements regarding interference suppression on radio and TV.
- After the product has been repaired, it should function properly and has to meet the safety requirements as officially laid down at this moment.

TECHNICAL INFORMATION

- Voltage : 100 - 240 Volt
- Motor voltage : 2,4 Volt
- Cutter need no oiling

DISASSEMBLY- AND RE-ASSEMBLY ADVICE

- No specific issues

REPAIR INSTRUCTIONS

- No specific issues

OPTIONAL (accessories)

- No specific issues

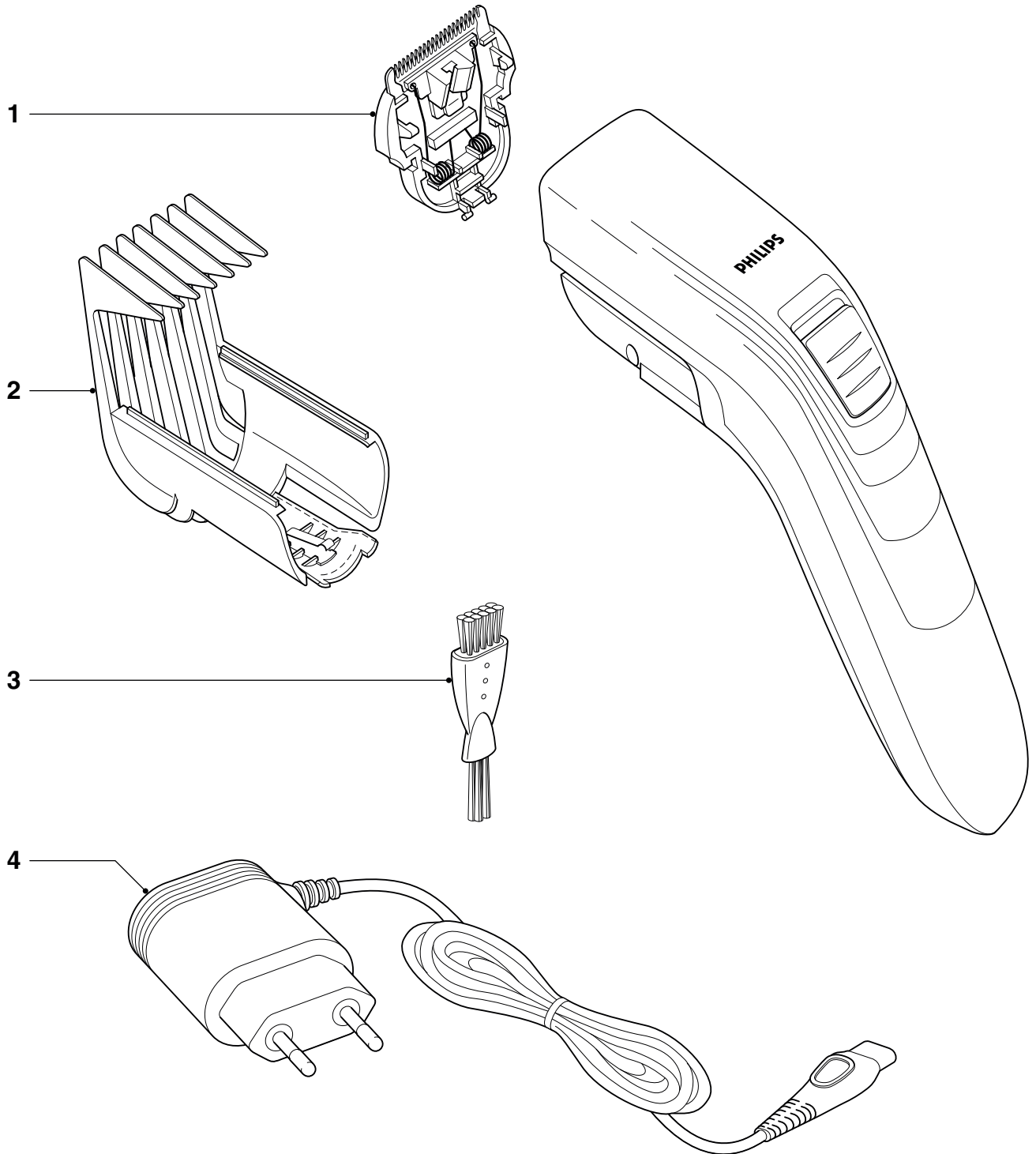

| Pos | Service code | Description |
|-----|----------------|-------------------|
| 1 | 4222 036 17510 | Cutter |
| 2 | 4222 036 17520 | Comb |
| 3 | 4222 036 02770 | Brush |
| 4 | 4222 036 04080 | Power plug EUR |
| | 4222 036 05160 | Power plug NOR |
| | 4222 036 05120 | Power plug AUS/NZ |
| | 4222 036 04090 | Power plug GBR |

| Pos | Service code | Description |
|-----|----------------|-------------------|
| 4 | 4222 036 05110 | Power plug CAN/TW |
| | 4222 036 03810 | Power plug MEX |
| | 4222 036 04850 | Power plug KOR |
| | 4222 036 03870 | Power plug JAP |
| | 4222 036 10320 | Power plug PRC |
| | 4222 036 03760 | Power plug ARG |